

Chilled Water Systems



YVWA | VSD Screw Compressor | 125 – 300 Tons | R-513A, R-1234ze | **Heat Pump** | 10% Turndown



YVWH | Water to Water VSD Screw **Heat Pump** | 4,050 MBH Heating 200 Tons Cooling | R-1234ze, R-515B



YMC² | Oil Free Magnetic | 165 – 1000 Tons | R-1234ze, R-515B, R-513A | 0.1-0.2 kw/ton | **Heat Pump** | **OSP Certified**



YZ | Oil Free Magnetic | 150-2000 Tons | R-1233zd(e) | Widest Operating Map | GWP = 1



YK | Centrifugal Compressor | 250 – 3000 Tons | R-1234ze, R-513A, R-515B | **Heat Pump and Heat Recovery** | Connected Chiller | **OSP Certified**



YD, YK-EP, CYK, OM | Up To 6000 Tons | R-1234ze, R-513A | **Heat Pump** | District Cooling



YST | Steam Turbine Drive Centrifugal | 700 – 2,800 Tons | CHP, Comfort Cooling, Process Cooling



YHAU / YHAP | Absorption Chillers / **Heat Pumps** | 30 – 2000 Tons | Hot Water, Steam, Gas, Oil



YLA | Scroll Compressors | 40 – 230 Tons | R-454B | **Heat Recovery** | VSD Pump Package | **OSP Certified**



YVAA | VSD Screw Compressor | 150 – 575 Tons | R-1234ze, R-513a | Industry Leading IPLV | **OSP Certified**



YVFA | Free Cooling VSD Screw Compressor | 115 – 500 Tons | R-513a , R-1234ze | Closed and Open Loop



SAMSUNG
DMV | Modular Chiller | 10 – 15 Ton Modules | Up to 240 Tons | **Heat Pump** | R-32

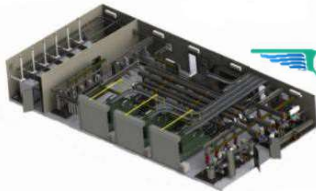

YORK® YMAE Air-to-Water Inverter Scroll Modular **Heat Pump/Heat Recovery**: 2-pipe or 4-pipe modular design delivers 140 °F (60 °C) water in capacities exceeding 3,000 MBH (~1,000 kW) **OSP Pending**

Modular Chiller Plants | “Chiller in a Box” | UL Listed | NEC Code Compliant | Cooling Tower Integration | Boiler Integration | Integrated Pumping Systems | Water Filtration and Treatment Systems | Environmentally Controlled Enclosure | BMS Integration | Seismic Design

Air Handling Units



Intelligent cooling
an ICT Company

Fully Custom Designed and Built AHU
ISO-9000 Certified- Phoenix, AZ

- 200 – 250,000 + CFM
- Fan Array | Energy Recovery | UV / BPI
- Lab Application – High Plume Exhaust
- Evaporative Cooling (Direct & Indirect)
- Custom Rooftop DX Package
- Penthouse Units, Chiller Boxes / Chiller Plants
- Cleanroom / High Filtration Applications
- Data Center Rack Cooling



Semi & Fully Custom AHU – York, PA

- Semi-Custom: 2,000 – 120,000 CFM
 - Indoor & Outdoor Application
- Full Custom: 2,000 – 200,000+ CFM
- Built in the USA
- Fan Array | Energy Recovery | UV / BPI
- Triple Membrane Roof
- Full-Service Vestibule
- Lab Application – High Plume Exhaust
- Cleanroom / High Filtration Application
- OSHPD Seismic Certification



Commerical & Residential Packaged DX & Split Systems



All refrigerant R-454B



Sunline | 3 – 6 Tons | AC, Gas, Electric, Heat Pump | Smart Equipment Controller



Pro | 3 – 12.5 Tons | Highest Efficiency Up To 21.1 IEER | Dual Circuit Option | Premium Features



Large Sunline | 15 – 25 Tons | AC, Gas, Electric, HP | 4 Circuit Option | High Efficiency Up to 18.0 IEER



Select | 27.5 – 50 Tons | AC, Gas, Electric | Up to 16.0 IEER | Premium Features | Matches Competitive Curb



Commercial Split | 7.5 – 40 Tons | AC, Heat Pump, Steam, Water | multi-position | 2 & 4 Pipe Configuration



Core | 3 – 12.5 Tons | AC, Gas, Electric, Heat Pump | Matches Competitive Curbs w/o Adapter Curb



Choice | 15 27.5 Tons | A/C, Gas, Electric | 14.8 IEER | Lightest in Industry | Mod Gas & Exhaust Fan



Millennium | 25 – 40 Tons | AC, Gas, Electric, Water, Steam | Double Wall Construction



Premier | 25 – 150 Tons | AC, Gas, Electric, Steam, Water | Up To 16.7 IEER | ERW | HEPA | Humidifier

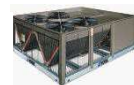

Full Residential Portfolio | 1.5 – 5 Tons | AC, Heat Pump | Air Handler | Gas Furnace | Loose Coils | Packaged | Suitcase Style Condensing Unit | Humidifier.



Variable Refrigerant Flow – Split System

All refrigerant R-32



DVM VRF | Up To 40 Tons | Heat Pump & Heat Recovery | 208-460 /3/60 V | Extended Pipe Lengths | Full Range of Indoor Units | Data Storage Backup | Standalone & BMS Controls



DVM Mini | 2, 3, 4.5, 5 Tons | Heat Pump & Heat Recovery | 208-230/60/1 V | Up to 10 Indoor Units | 492' Total Pipe Length, 164' Vertical



DVM S Water Source | Up To 50 Tons | Heat Pump & Heat Recovery | 208-460 /3/60 V | Closed Loop Water or Geothermal Systems | Full Range of Capabilities as DVM VRF



RAC, CAC, FJM | Single & Multi Zone Split Systems | Heat Pump | 9MBH – 48 MBH | 208-230/3/60 V | Wi-Fi Samsung 'Smart Things' Technology | High Efficiency Options



Standalone or BMS Controls | Remote Monitoring | BACnet or Lon Works Gateway | Custom Control Logic | Wi-Fi Adapter for Samsung SmartThings | Wired / Remote T-Stat | 3rd. Party T-Stat Adapter

Dedicated Outside Air Systems



JR Series Unit | 3 – 70 Tons | Up to 18,000 CFM | AC, Gas, Water, Electric, Air Source HP, Water Source HP | Digital and VFD Scroll Compressors | Modulating Hot Gas Reheat | Energy Recovery Module | Double Wall Construction | MERV-14 Filters



Paragon Unit | 5 – 30 Tons | Up to 12,000 CFM | AC, Gas, Electric, Air Source HP | Inverter Scroll Compressors | Modulating Hot Gas Reheat | Energy Recovery Module | Double Wall | MERV 15 & HEPA Filters



iAIRE's DOAS units can have Solar HVAC installed on them. Solar HVAC makes iAIRE's DOAS product very efficient. RTUS from 3-150 Tons, Split systems 3-80 tons, units are all electric, Heat pump, gas heat or water heat system.

Terminal Unit & Water Source Heat Pump Products



VAV Box



Fan Powered Terminal



Fan Coil Unit Horizontal



Fan Coil Unit Floor Low Profile



Fan Coil Unit Floor Console



Fan Coil Unit Vertical



Blower Coil Unit



Water Source Heat Pumps

Heat and Ventilation Units



Unit Heater



Infrared Heater



Make Up Air Unit



Wall Panel Heater



Duct Furnace

Laboratory Ventilation and Exhaust Fans



Fan Systems
Exhaust Fans
Booster Fan



Exhaust Fan Systems
Ventilation / Bath Fans
Fresh Air Systems



Exhaust Fan Systems
Exhaust Fans
Gravity Ventilators

Evaporative Coolers



Evaporative Cooler / Media
 Ventilation



High Efficient Evaporative Cooler Solutions

Wall Mount Package Units



Wall Mount Gas Electric and Heat Pump
 Telecommunication Solutions
 K-12 Solutions
 Modular Solutions



Cooling Towers



Cooling Towers & Fluid and Dry
 Coolers
 Open/Closed Cooling Towers
 Modular option, Fiberglass



Zoning Systems



T-Stats & Controls



Commercial & Residential Thermostats
 Wi-Fi Compatible
 Remote Smartphone Control Title 24 Compliant



Indoor Air Quality



Bipolar Ionization
 UV Lights
 Self-Contained & Stand-Alone Systems



Unit Accessories



RTU & Split Accessories Curbs: Calculated, Pitch,
 Vibration, Curb Adapters Economizers, Power
 Exhaust, Hoods



Coil Coatings
 Evaporator & Condenser
 & Cabinet



Powering Business Worldwide

Variable Frequency Drives New and
 Retrofit Commercial and Industrial